

## ✕ □ Labels ≡

Shareable Label Themes

Set / Reset label colors,

Select label groups,

Filter used / unused label colors,

Works with Composition and Project Items,

Supports custom label colors

Take full controll over Label Colors

# Labels

Nothing you couldn't have done the hard way

Labels is After Effects script that takes full control over Label Colors - set label colors and select label groups with a single button click. Works both for composition and project panel items.

Themes brings power to After Effects to switch Label Colors at any time without the need to restart application. Try different Labels colors, assignments, and save them to file to share with the team. Additionally, download Themes on the bottom of the page to give your timeline a facelift.

## Installation

1. Unpack the archive you have downloaded and copy/paste files (both "Labels.jsx" and "Labels Help.pdf") to "ScriptUI Panels" folder:

- Windows: [Program Files\Adobe\Adobe After Effects <version>\Support Files\Scripts](#)
- Mac OS: [Applications/Adobe After Effects <version>/Scripts](#)

If folder [ScriptUI Panels](#) does not exist, create a folder and name it "ScriptUI Panels". Then paste the copied files into it.

2. Allow script to access network to avoid unnecessary problems while loading GUI. This option is under [General](#) tab of After Effects [Preference](#) pane:

- Windows: [Edit > Preferences > General](#)
- Mac: [After Effects > Preferences > General](#)

Once installation is finished run the script by clicking [Window > Labels](#)

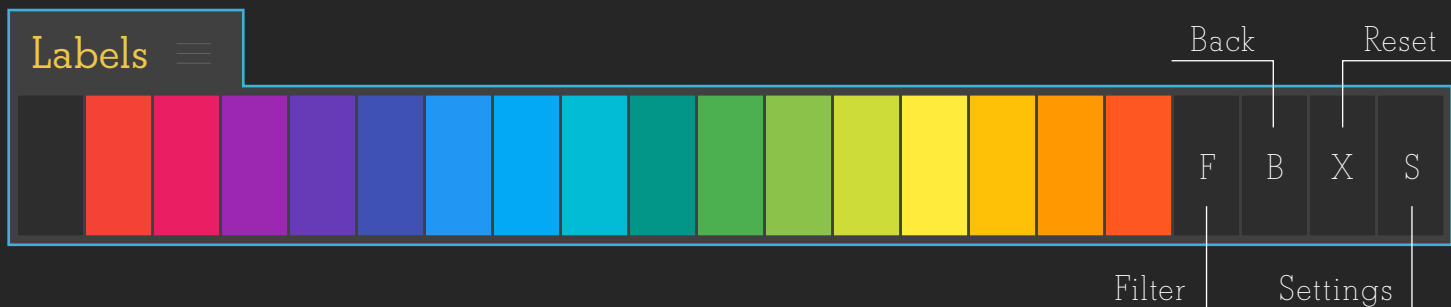

## Interface

Interface is as simple as it gets. Each color swatch represents a label color.

Note: Script works with custom label colors as well.

Filter (F) shows which labels are used in the current composition or the project panel. Alt+Click will filter unused ones.

Back (B) brings all available color swatches.

Settings (S) opens up Settings window for changing Label Theme and customising keyboard combination.

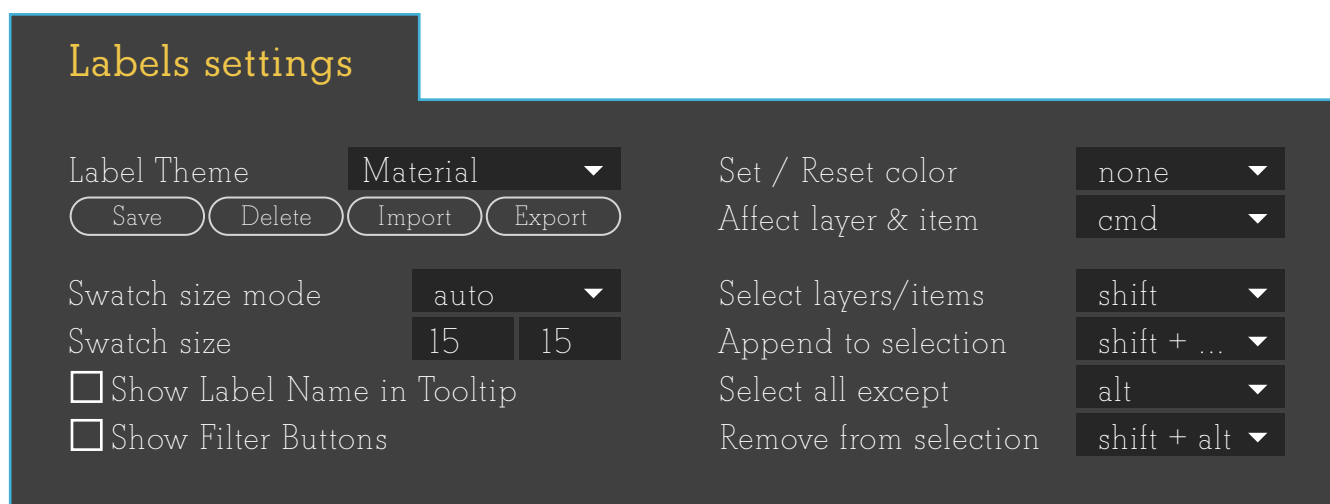

Labels brings possibility to share label colors. You can switch Labels Theme any time in your project without the need to restart After Effects.

# Settings

[Label Theme](#) - select available Label Themes from the list.

[Save](#) - saves current Label Preferences to the theme.

[Delete](#) - deletes theme from the dropdown list.

[Import](#) - imports theme file and adds it to the list.

[Export](#) - exports selected theme from the list.

[Swatch Size Mode](#) - auto/fixed.

[Swatch Size](#) - swatch size in [fixed](#) mode.

[Show Label Name in Tooltip](#) - toggle tooltip visibility.

[Show Filter Buttons](#) - toggles visibility of F and B buttons in Labels UI.

[Set / Reset color](#) - set layer or label color.

[Affect layer & item](#) - sets same label color to layer and source item.

[Select layers/items](#) - select same label color.

[Append to selection](#) - adds current label color to selection.

[Select all except](#) - selects all layers/items except current label color.

[Remove from selection](#) - removes current label color from selection.

## Label Themes:

[Conigs](#) theme by Paul Conigliaro <http://conigs.com>

[Generic 16 CGP](#) by Arne Niklas Jansson <http://androidarts.com/palette/16pal.htm>

[Material](#) based on Google Material Design <https://material.io>

[Pastel](#) collection of pastel colors

[Pico-8](#) based on PICO-8 Game Console Palette <http://www.lexaloffle.com/pico-8.php>

[Vivid](#) almost random colors with bold hues

## ✕ □ Labels ≡

Shareable Label Themes

Set / Reset label colors,

Select label groups,

Filter used / unused label colors,

Works with Composition and Project Items,

Supports custom label colors

by Tomas Šinkūnas  
[www.rendertom.com](http://www.rendertom.com)